

4 HOLES $\frac{3}{4}$ "
ON $35\frac{1}{4}$ " B. C.
COUNTERBORE
 $1\frac{1}{16}$ " ϕ X $\frac{11}{16}$ " DEEP
FOR $\frac{3}{8}$ " SOCKET
HD. CAPSCREWS
2" LONG

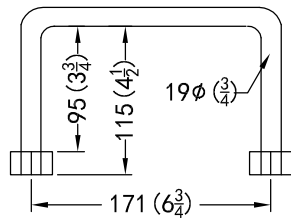

SECTION B-B

STEEL HANDLE TO BE
INSTALLED THRU HOLES
WITH HEXNUTS WELDED

HANDLE

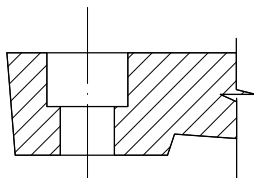

SECTION C-C

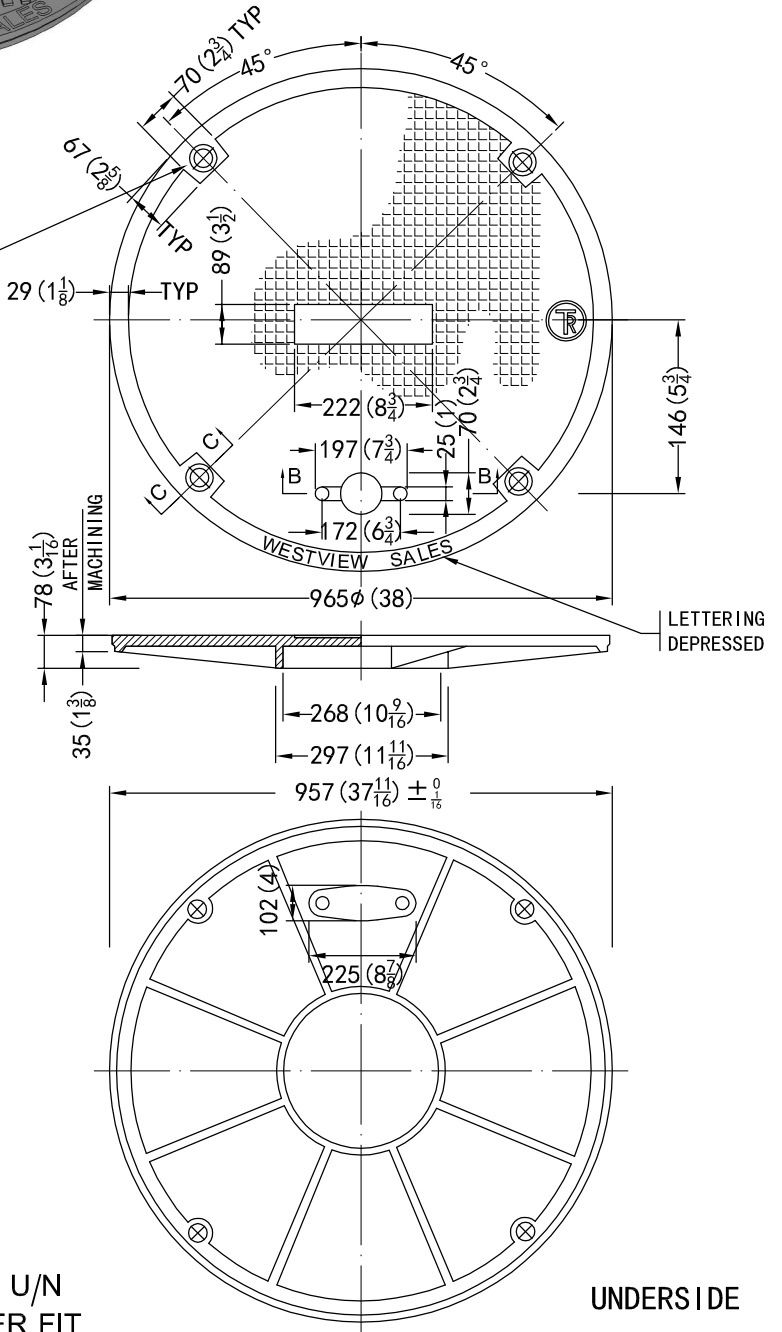

NOTES:
MAT'L: DUCTILE IRON
ALLOWABLE TOLERANCE $\pm \frac{1}{16}$ U/N
MACHINE FOR NON.ROCKER FIT
FINISH: BITUMINOUS DIP

WESTVIEW SALES LTD.

TR36 W/T COVER