

CAST IRON & BRASS PLUG

32mm PIPE SCH. 40 GALV

10mm SET SCREW

25mm GALV PIPE SCH. 40

TYPE "A" (THERADED)

MACHINED THD TO 1 1/4" Ø STD PIPE

DRILL & TAP FOR 10 Ø HEX HD. SCREW (GAL' D)

TYPE "B" (SOCKET WITH SETSCREW)

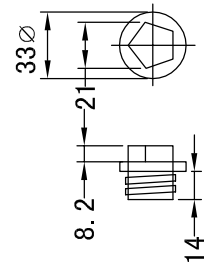

BRONZE PLUG

NOTES:
 MAT'L:ASTM A48 CLASS 25 GREY IRON
 FINISH:BITUMINOUS DIP
 LOADING:H2O

WESTVIEW SALES LTD.	SMALL SERVICE BOX	SB-1
---------------------	-------------------	------